

4088

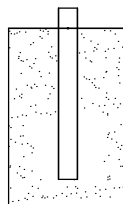
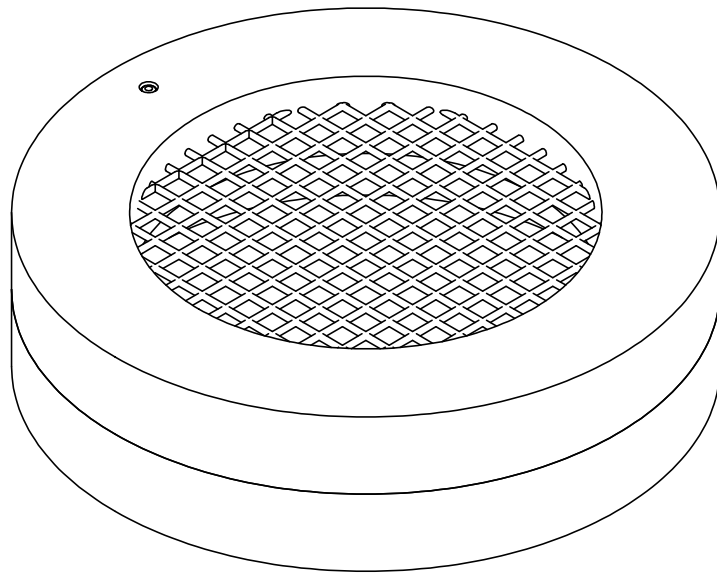
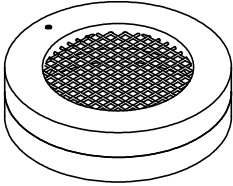
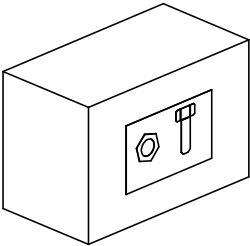
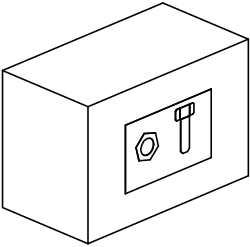

4088N

NR	ELEMENT	4088N
E1		1
E2		1

				4088N	
--	--	--	--	-------	--

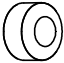
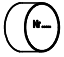
Nr	Element			Σ	
213		-	Z_NA_1	1	
214		-	Z_NA_2	1	

4088N

"0"

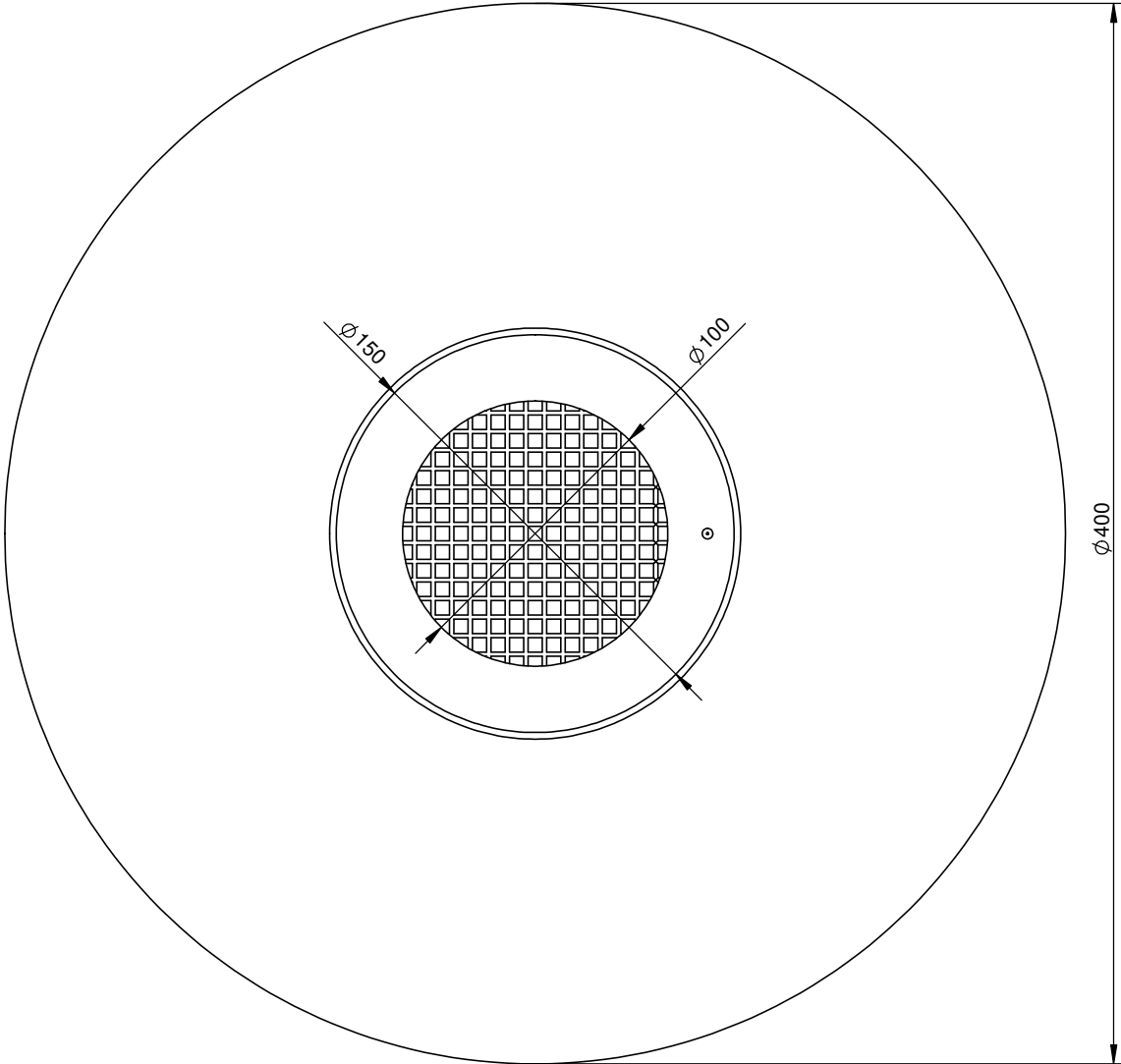

1

4088N

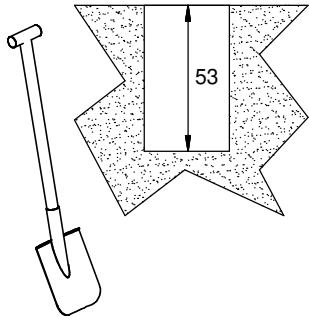

A-A (1 : 20)

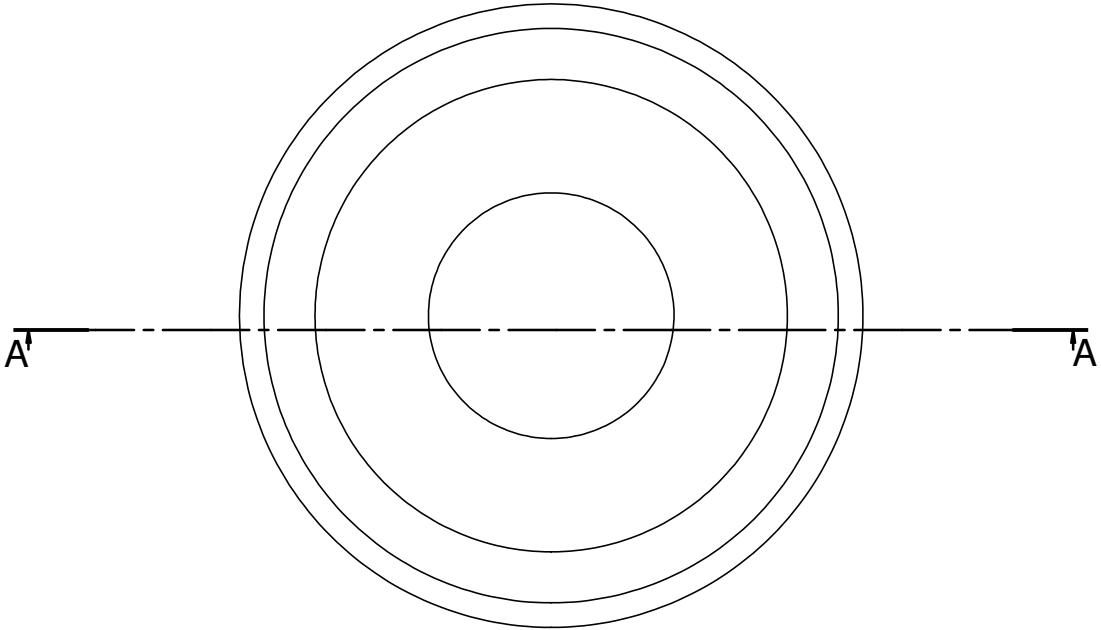
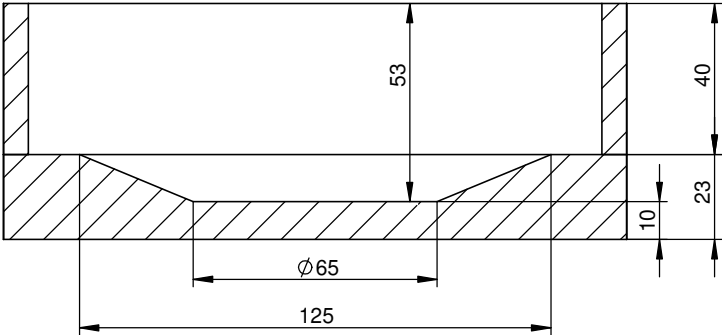

2

4088N

I)

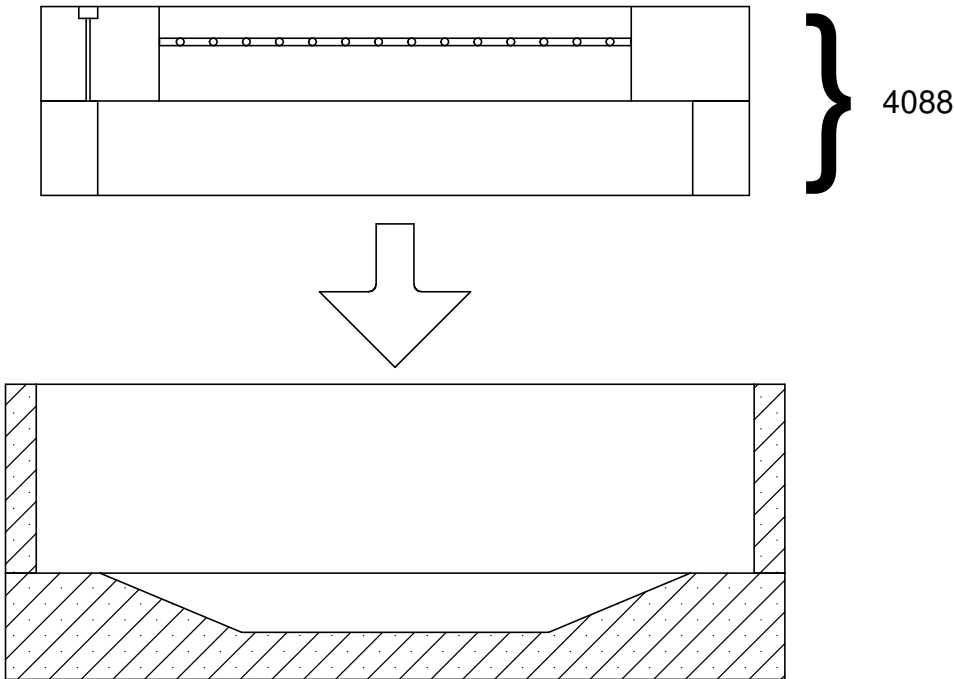

II)

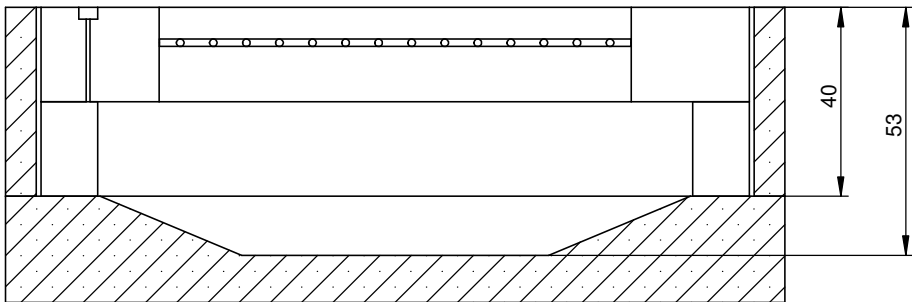

3

4088N

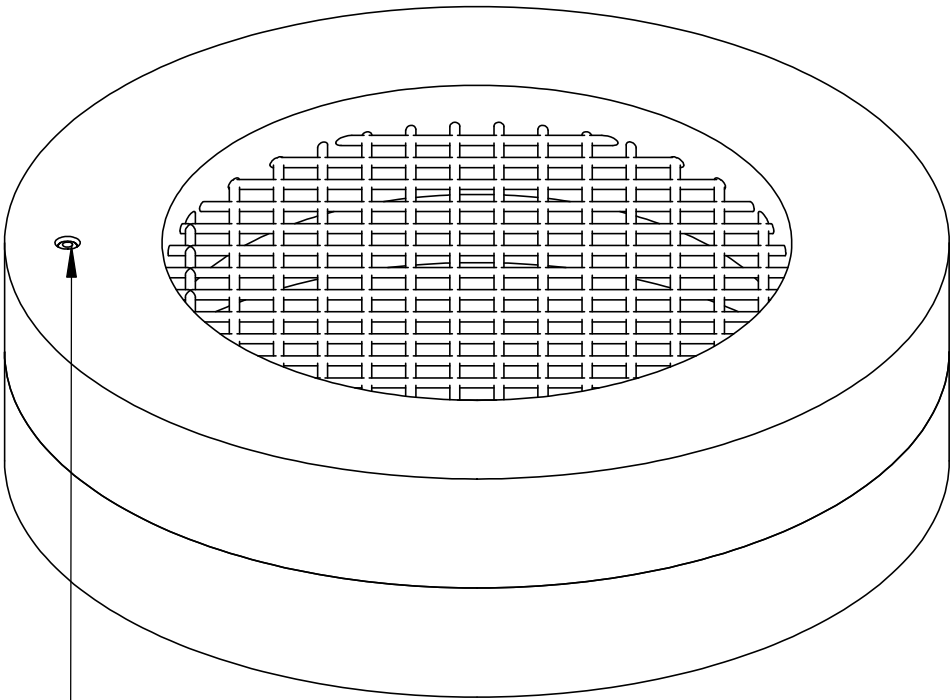

INST_Z_6